



NESS TWR MICRO REED SWITCH



The Ness Two Way Radio Micro Radio Reed Switch battery operated radio transmitter with internal reed switch.

The ultra low profile body of the reed switch and magnet allows for unobtrusive installation on door and window frames in cases where it's not possible to run wires.

TWR Micro Reed Switch operates on the 915.8MHz ~ 927.2MHz band with frequency hopping for enhanced security and signal integrity.

- Monitor doors, windows, drawers, garage doors and other openings.
- Compatible with Ness and Elk Two Way Radio devices
- Long Battery Life
- Low Battery report and Indication
- Self adhesive pad mounting
- Ultra low profile

INSTALLATION NOTES

OVERVIEW

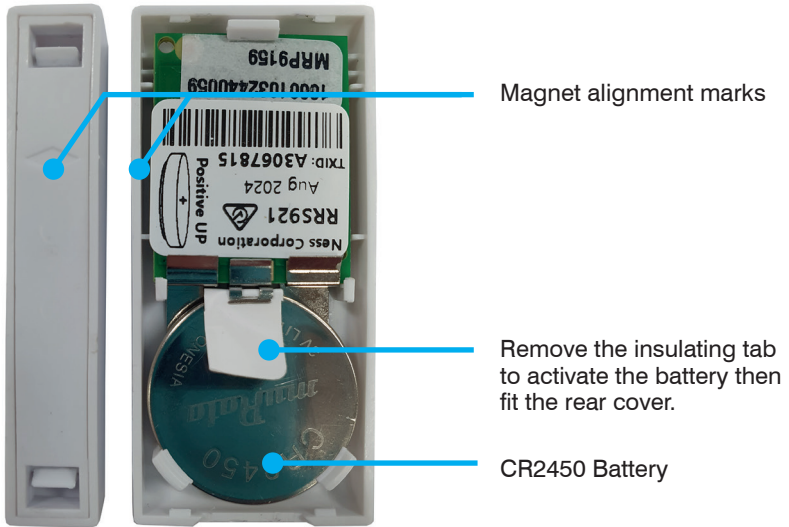
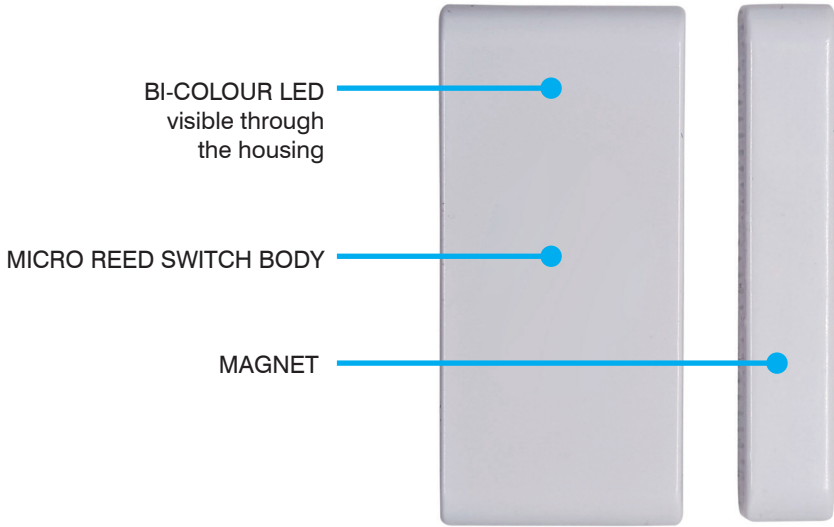

Internal components

INSTALLATION

The reed switch body and magnet should be affixed to the door or window and frame with the self adhesive pads provided.

Ensure that all surfaces are dust free and clean of oily residue.

Installation on metal surfaces should be avoided. Metallic objects may reduce radio range.

BATTERY

A 3V lithium battery is supplied (CR2450).

The device will send a low battery signal when the battery voltage falls below 2.47V @ 25°C ambient temp.

Battery life depends on the number of transmissions per day and will be shorter when used in high traffic applications.

MAGNET ALIGNMENT

The alignment arrows on the reed switch body and magnet must be in line when the door/window is closed.

The gap between the reed switch body and magnet must not exceed 10mm.

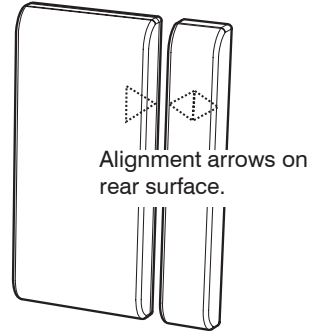

ENROLMENT

Power up (insert the battery or remove the insulating tab) to send the learn/enrolment signal.

● GREEN LED

Flash (100mS)	Successful acknowledgment received for an open or close message when the battery is OK
Brief Flash (20mS)	Successful acknowledgment received for supervision or battery status message.

● RED LED

5 brief flashes	Successful acknowledgment received for an open or close message when the battery is low.
Brief Flash	Transmit/receive timeout. ie Reed switch attempted to transmit and failed to receive a response.

SPECIFICATIONS

Product	106-111 Ness TWR Micro Reed Switch
Compatibility	Ness TWR transceivers / Elk M1
Frequency	915.8MHz ~ 927.2MHz frequency hopping
Visual Indicator	Bi-Colour LED, Red/Green
Battery	1 x CR2450 3V
Current, Standby/Working	2.7uA / 22mA
Operating Temperature	-10°C to 40°C
Dimensions	60(H) x 30(W) x 8(D) mm

Ness Corporation manufacturing processes are accredited to ISO9001 quality standards and all possible care and diligence has been applied during manufacture to ensure the reliable operation of this product. However there are various external factors that may impede or restrict the operation of this product in accordance with the product's specification.

These factors include, but are not limited to:

1. Erratic or reduced radio range. Ness radio products are sophisticated low power devices, however the presence of in-band radio signals, high power transmissions or interference caused by electrical appliances such as wireless routers, cordless phones, computers, TVs and other electronic devices may reduce the range performance. While such occurrences are unusual, they are possible. In this case it may be necessary to either increase the physical separation between the Ness receiver and other devices or if possible change the radio frequency or channel of the other devices.
2. Unauthorised tampering, physical damage, electrical interruptions such as mains failure, electrical spikes or lightning.



CORPORATION

www.ness.com.au

National Customer Service Centre
Ph: 1300 551 991 (Australia only)
techsupport@ness.com.au



Document Part No. 890-509
Rev 1.0 August 2024

For products:
106-111 Ness TWR Micro Reed Switch

© 2024 Ness Corporation Pty Ltd ABN 28 069 984 372
Specifications may change without notice.

