

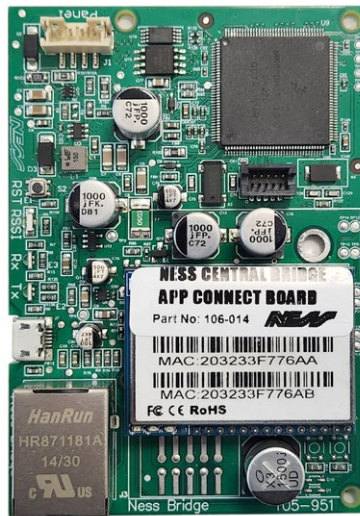

**YOUR
DPLUS/D8/D16
PANEL**

**FREE
MEZZO
APP**



INTERNET

NESS CLOUD

**NESS-BRIDGE ETHERNET INTERFACE MODULE
NESS MEZZO APP**

Installation & Operation Manual

Rev 1.5



CORPORATION

Innovative Electronic Solutions

www.ness.com.au

National Customer Service Centre

Ph: 1300 551 991

techsupport@ness.com.au



NESS-BRIDGE ETHERNET INTERFACE MANUAL

Document Part No: 890-506

Rev 1.5 Mar 2025

Applies to 106-014 Ness-Bridge Ethernet Interface.

All rights reserved. No part of this publication may be reproduced, transmitted or stored in a retrieval system in any form or by any means, electronic, mechanical, photocopying, recording, or otherwise, without the prior written permission of Ness.

Ness reserves the right to make changes to features and specifications at any time without prior notification in the interest of ongoing product development and improvement.

© 2025 Ness Corporation Pty Ltd ABN 28 069 984 372

CONTENTS

Overview	3
Compatibility	3
Hardware Overview / LEDs Operation	4
Hardware setup	5
Panel Programming	5
Install Mezzo app	6
App setup / Add Ness-Bridge	7-9
Activate Ness-Bridge in Ness Cloud	10-11
Setup DPlus/D8/D16 PIN in Mezzo app	12-13
Synchronise with Ness Cloud	14
Select Push Notifications	15
OPERATION, Arm / Disarm / Home Mode / Operate Outputs	16-19

OVERVIEW

Ness-Bridge is an easy to install ethernet interface providing internet connectivity for Ness DPlus/D8/D16 control panels.

Ness-Bridge in combination with the free **Ness Mezzo** app provides handy remote operation features for your Ness control panels.

- Arm and Disarm
- Home Mode operation
- Operate panel outputs*
- Receive Push Notifications for Arm/Disarm and alarm events
- View zones and panel status

* Outputs require optional 106-013 Relay Board/s. Other conditions apply, refer to page 19.

COMPATIBILITY

Ness-Bridge is compatible with:

Ness Control panels

DPlus
D8XD / D16XD (Rev6 and later)
D8XCEL 4G / D16XCEL 4G

Mobile Devices

Android: 7.1 or later
iPhone: iOS 15.0 or later

INCLUSIONS

106-014 Ness-Bridge Module is supplied with:

- 1 x Ness-Bridge module
- 1 x 450-233 4-wire loom
- 2 x Red slider mounting rails

HARDWARE

106-014 Ness-Bridge module

4-Pin header connects via the 4 wire loom to the DPlus/D8/D16 serial port

Reset Button

RSSI LED

RX LED

TX LED

USB Port (Factory use only)

RJ45 Ethernet port

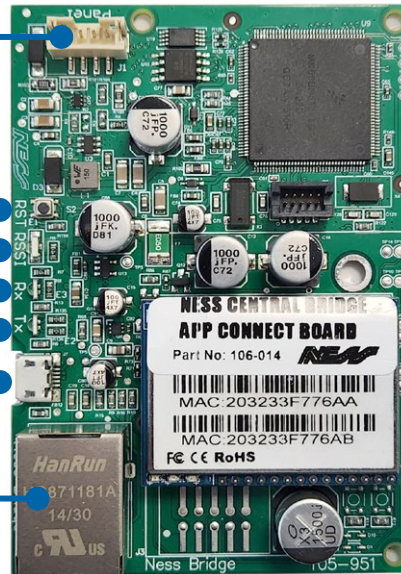

LEDS OPERATION

RGB LEDs	RED	GREEN	BLUE
RSSI		Boot up, Normal run	
RX	Error code	Flashing, receiving data	
TX	Default All, Default Ethernet	Flashing, sending data	Fast flash 5 seconds for fully defaulted unit

HARDWARE RESET

To default ALL SETTINGS

To default all Ness-Bridge hardware and user settings and reboot the Ness-Bridge module press and hold the RST button for 30 seconds.

TX RED LED will flash continuously during boot-up followed by a single flash from RSSI LED when completed (approx 3 minutes).

To default ETHERNET settings

To default the Ness-Bridge Ethernet settings to factory settings, press RST button twice, (long press, 2 seconds each press).

TX RED LED will confirm the action.

TX RED LED will flash continuously during boot-up followed by a single flash from RSSI LED when completed (approx 3 minutes).

HARDWARE SET UP

Install the Ness-Bridge module in your panel housing using the red slider rails provided and connect the 4 wire loom to D8/D16 SERIAL port.

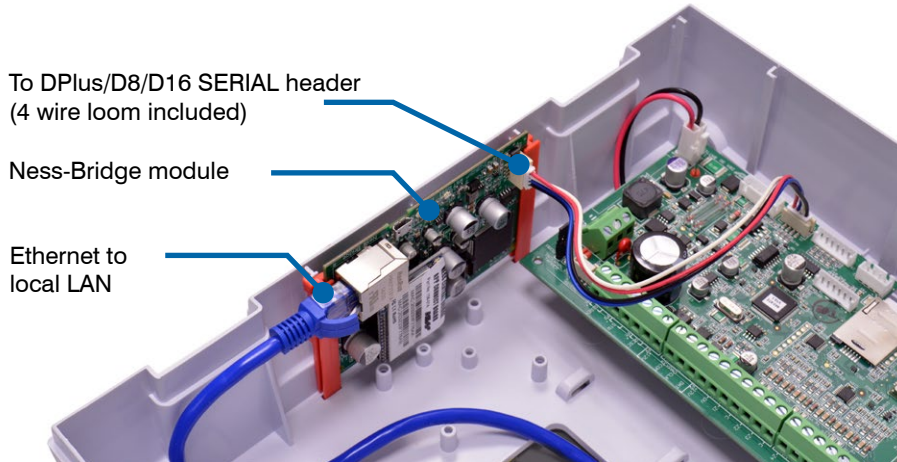

Connection to current version panels with 4-pin serial port

Ness-Bridge connection to DPlus, D8x/D16x V8.x and D8/D16 XCEL
Use the 4 wire loom supplied with Ness-bridge module.

106-014 Ness-Bridge Ethernet Interface
4pin Serial Header

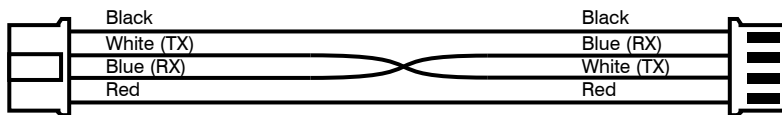

Control Panel
4-pin Serial Header

Connection to previous models with 3-pin serial port

Ness-Bridge connection to older D8/D16 V6.x/V7.x 3-pin Serial Port

Use the 4 wire loom supplied with Ness-bridge and join to a 450-185 serial lead 3pin (cut off and discard the DB9 plug).

106-014 Ness-Bridge Ethernet Interface
4pin Serial Header

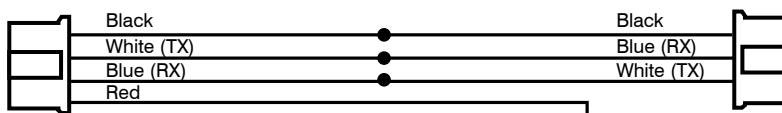

D8X/D16x V6.x/V7.x
3-pin header

Note.
Before cutting the original wire loom.
The two ends of the wire loom are not the same.
The Ness-Bridge end is wired as above - note the positions of Blue and White with respect to Black and Red.
TX/RX connection is cross-over.

D8/D16 +12V

PANEL PROGRAMMING

In the DPlus/D8/D16 panel, enable serial port options at P199E. Installer Programming mode.

P199E, turn on options 1E-7E

KPX+	P199E select options 1E to 7E
NAVIGATOR	P199E > select options 1 to 7

APP SETUP

1 Get MEZZO app from Google Play store or Apple App Store



ANDROID



iOS

2 Install Mezzo app

BEFORE YOU START

For security purposes, when adding a device, **your smartphone must be on the same network as the Ness-Bridge device.**

Once your Ness-Bridge has been successfully added and activated you'll be able to connect from any network.

DON'T FORGET

The serial port must be enabled in your DPlus/D8/D16 control panel.

P199E, turn on options 1E-7E (See page 5)

3 If you have a **Ness Cloud** account, enter your Email and Password to login.

To create a new account tap SIGN UP

TYPES OF USER ACCOUNTS

The first user added will automatically be the Admin account.

When additional users activate their Cloud account/s the new users will appear in your app in myUsers > Requests.

Add the new user as a Family or Guest user.

Family users can arm and disarm.
Guest users can only view events.

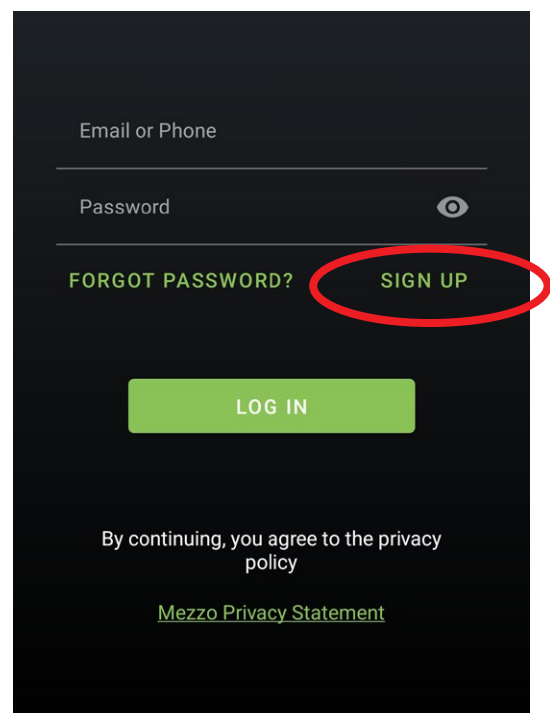

The screenshot shows a dark-themed login screen. At the top, there are two input fields: 'Email or Phone' and 'Password'. Below these fields are two links: 'FORGOT PASSWORD?' and 'SIGN UP'. The 'SIGN UP' link is circled in red. Below the links is a green button labeled 'LOG IN'. At the bottom, there is a line of text: 'By continuing, you agree to the privacy policy.' followed by a link to the 'Mezzo Privacy Statement'.

APP SETUP

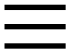
4 Tap the Menu icon  and choose Device List

5 Tap  to add your Ness-Bridge device



Ness Cloud is the online service providing login facilities for your Mezzo app and allows Mezzo app to connect to the Ness-Bridge module.

Access to Ness Cloud is free for basic operation of your devices via Ness-Bridge.

6 Tap Press To Scan the QR code on the rear of your Ness-Bridge device

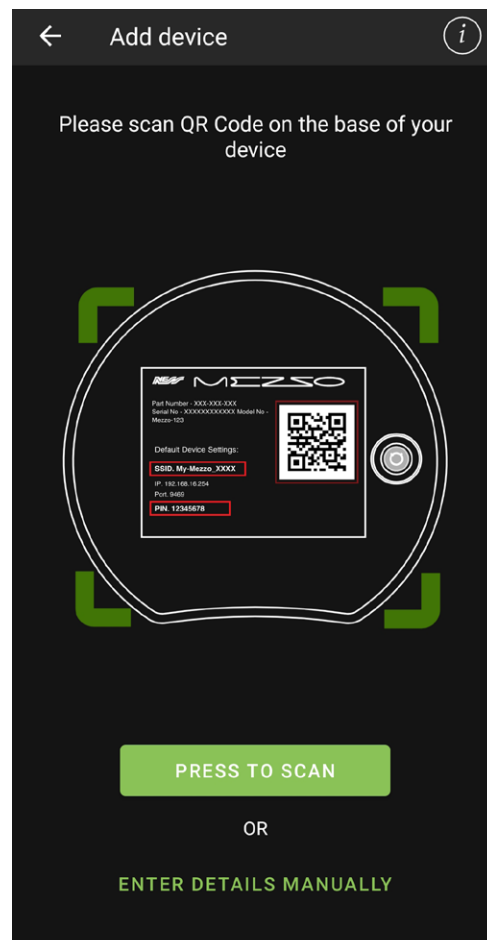
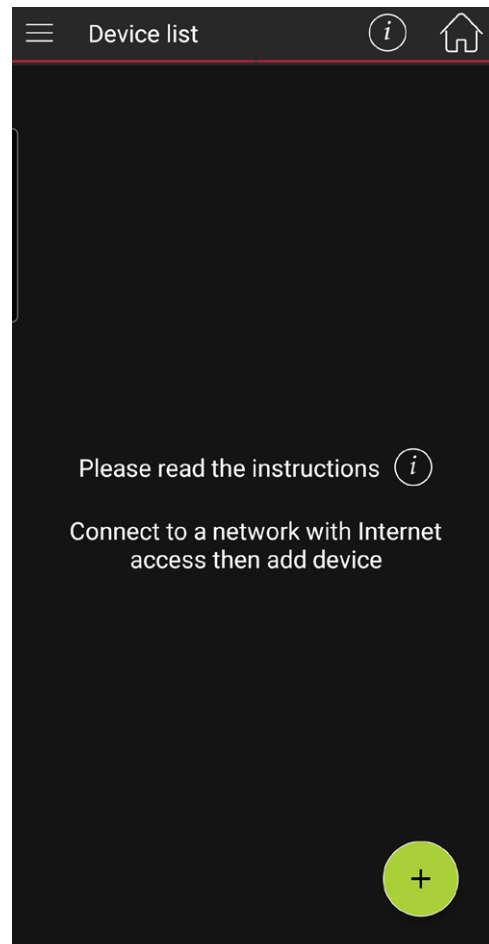

APP SETUP

7 Once the Ness-Bridge device is found, tap the device name to select.

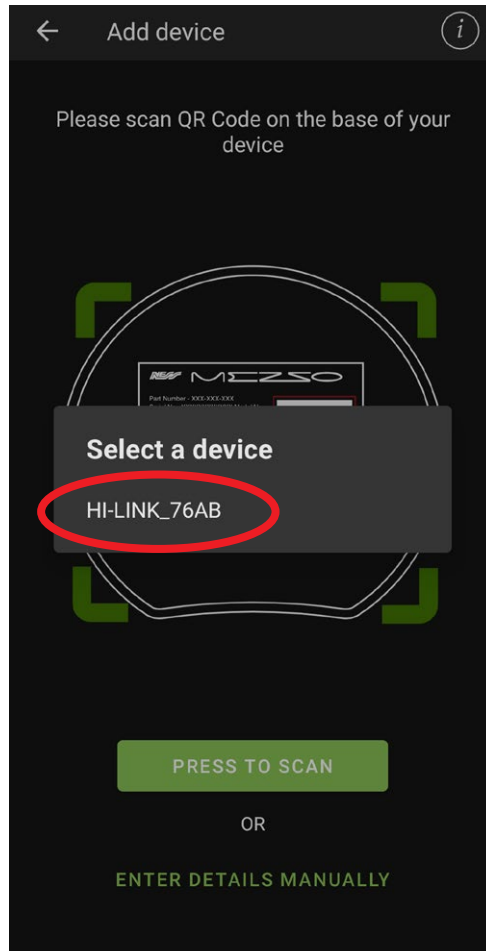

7a Mezzo app will connect to the device

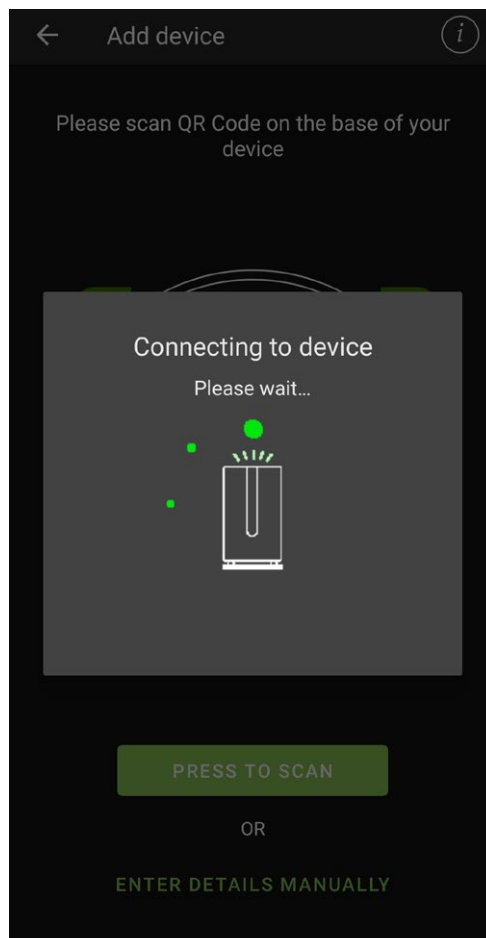

APP SETUP

- 8 Follow the instructions to set your location

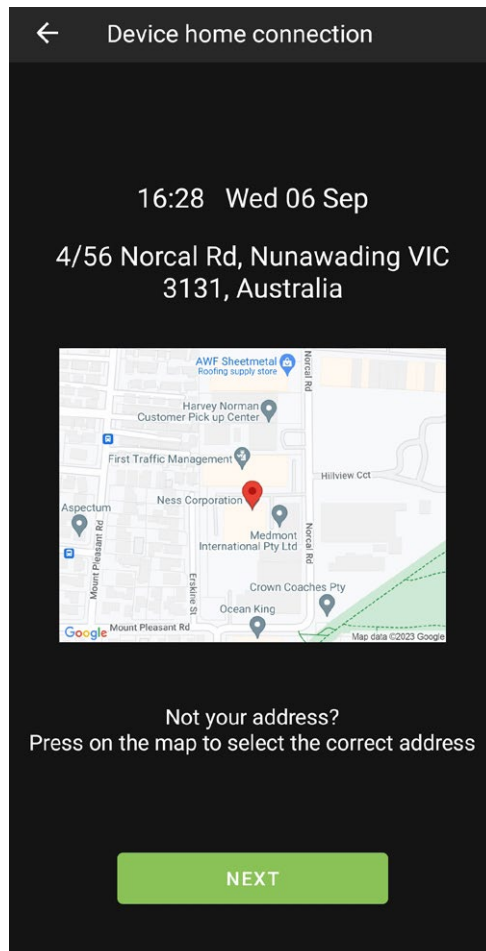

- 9 The device has been successfully added. Tap FINISH.

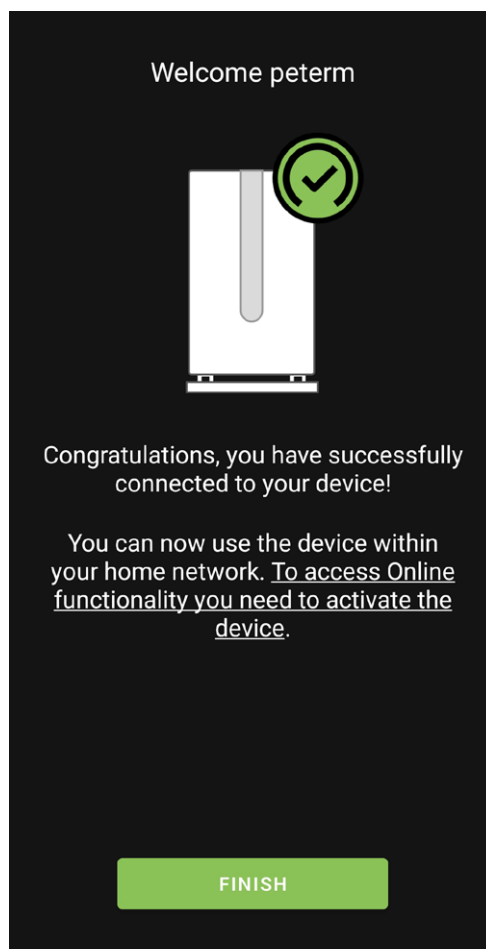

APP SETUP

10 Tap **ACTIVATE** to activate the device in the Ness Cloud.

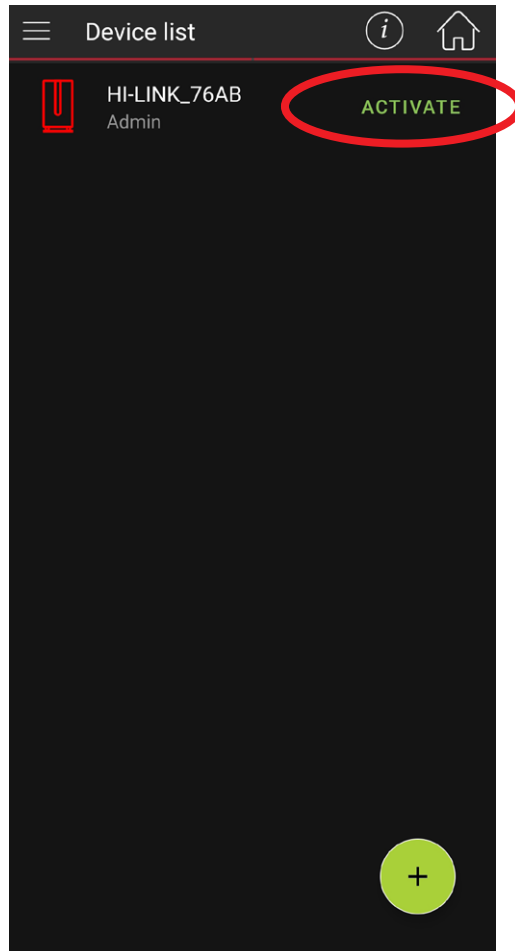

11 Tap **ACTIVATE** again.

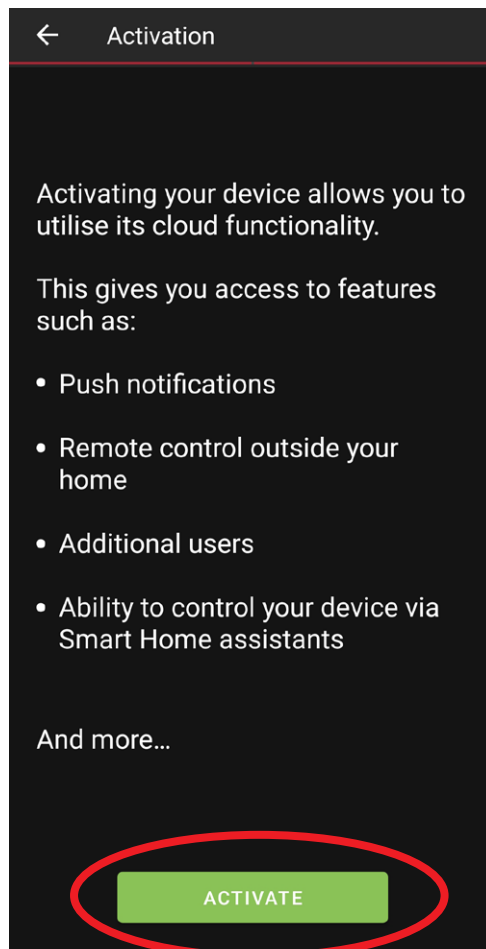

APP SETUP

- 12 The device will reboot after activating on the Ness Cloud.

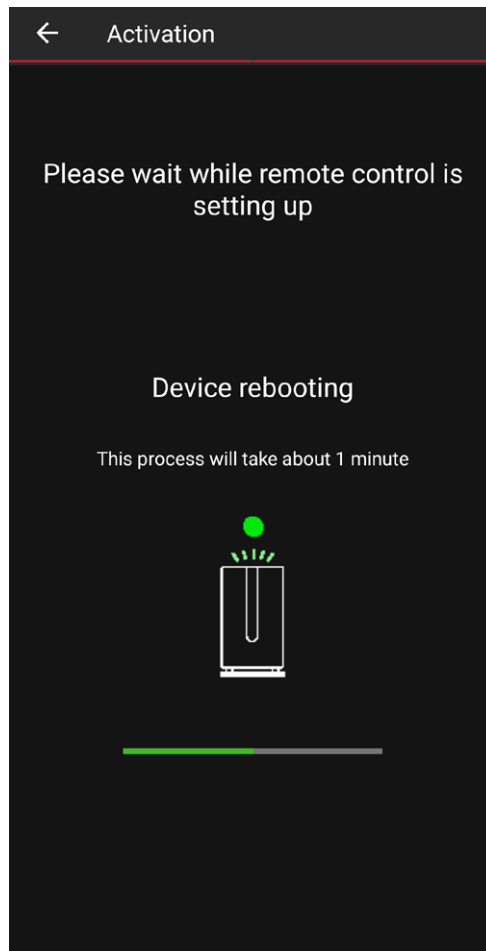

- 13 The device has been successfully added.

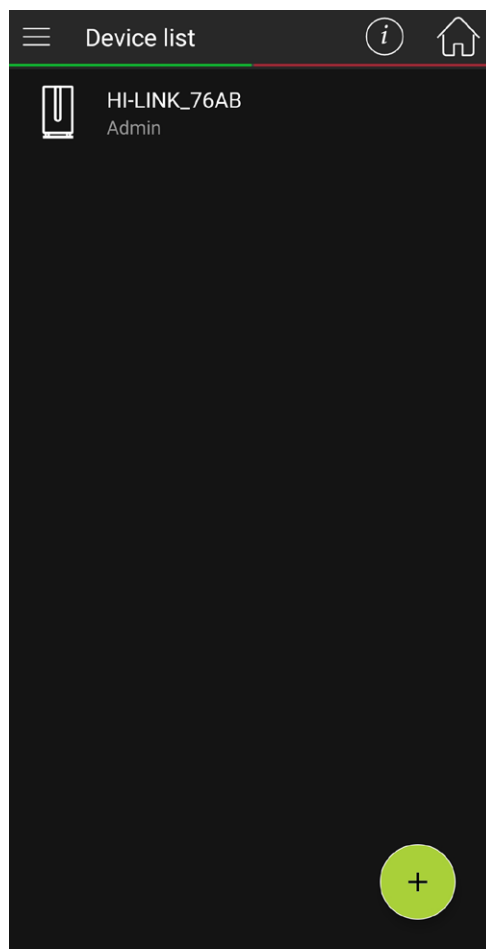

APP SETUP

Setup your PIN to match your user code in your DPlus/D8/D16 control panel.

14 Tap the Menu icon  and choose Users.

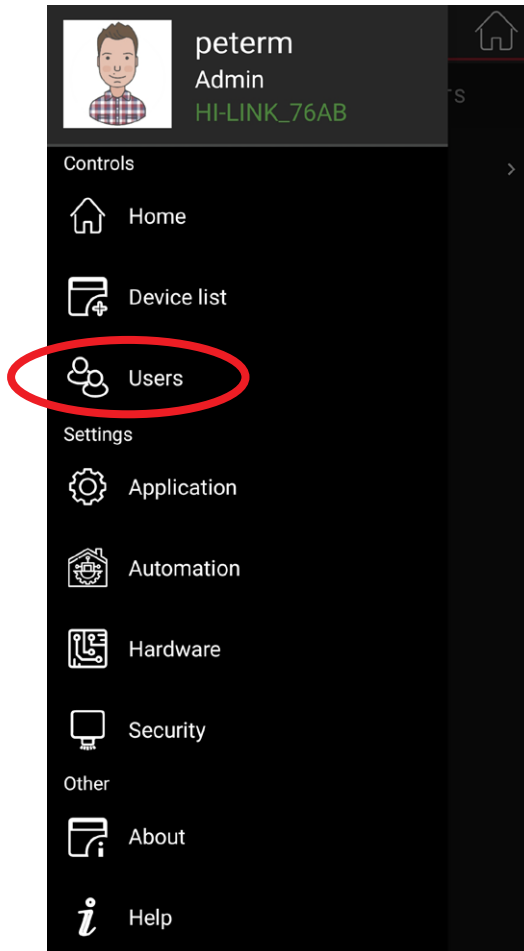

15 Tap your user account

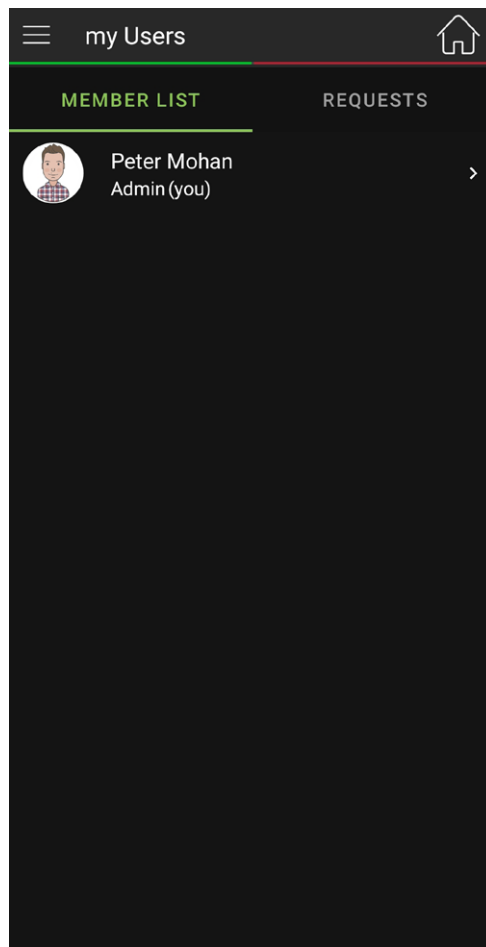

APP SETUP

- 16 On your profile page, tap CHANGE PIN CODE

User editing

Preferred name
peterm

First name
Peter

Middle name

Last name
Thecustomer

E-mail
example@provider.com.au

Phone number
0418 xxx xxx

CHANGE PASSWORD

CHANGE PIN CODE

SAVE

- 17 Enter a PIN to match your DPlus/D8/D16 user Code.



IMPORTANT

Each unique Mezzo app user must also have their own user code in the DPlus/D8/D16 control panel.

Example mapping of user codes:

MEZZO APP PIN	CONTROL PANEL USER CODE
1234	1234
5678	5678
2468	2468
... and so on	...

Example PINs. Please create your own unique codes.

- 18 Tap SAVE.

Change pin code

New pin code

Repeat new pin code

SAVE

APP SETUP

19 Next, synchronise your device settings with the Ness Cloud

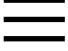
Tap the Menu icon  then tap Application.

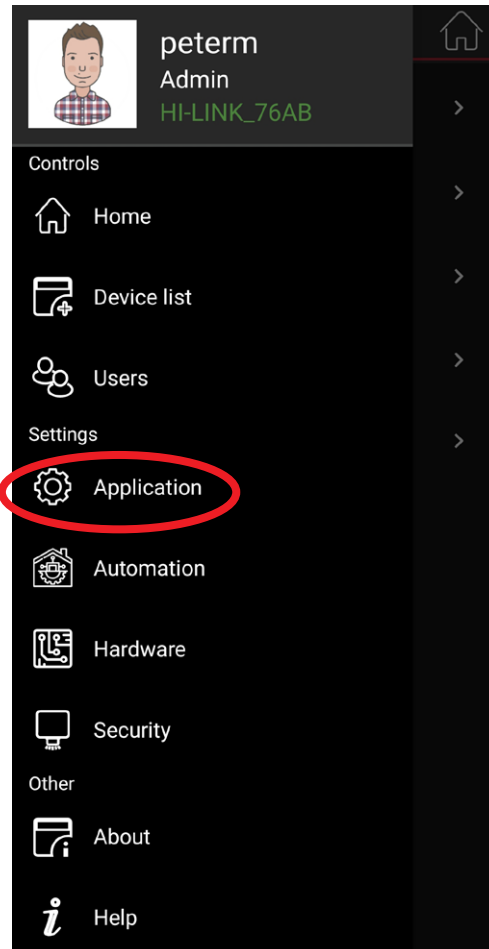

20 Tap Synchronise all

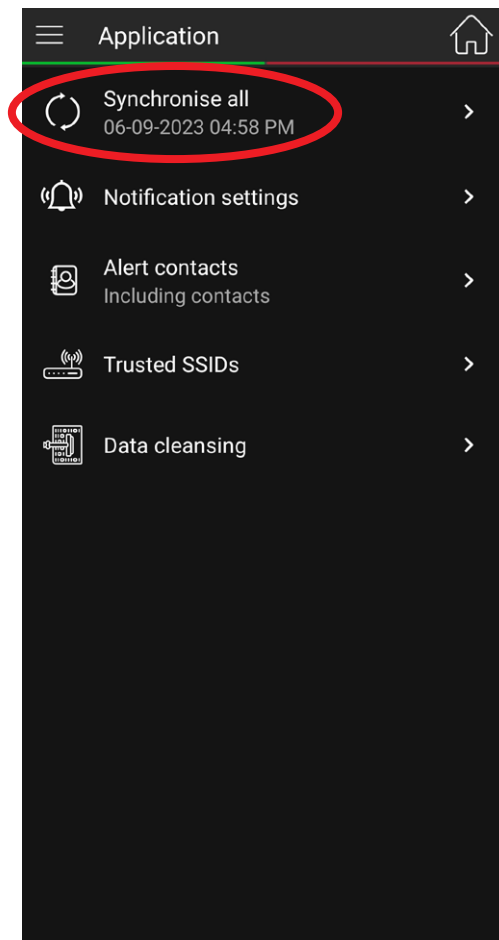

APP SETUP

21 You can choose which Push Notifications you'd like to receive on events.

Also in the Application menu, tap Notification Settings

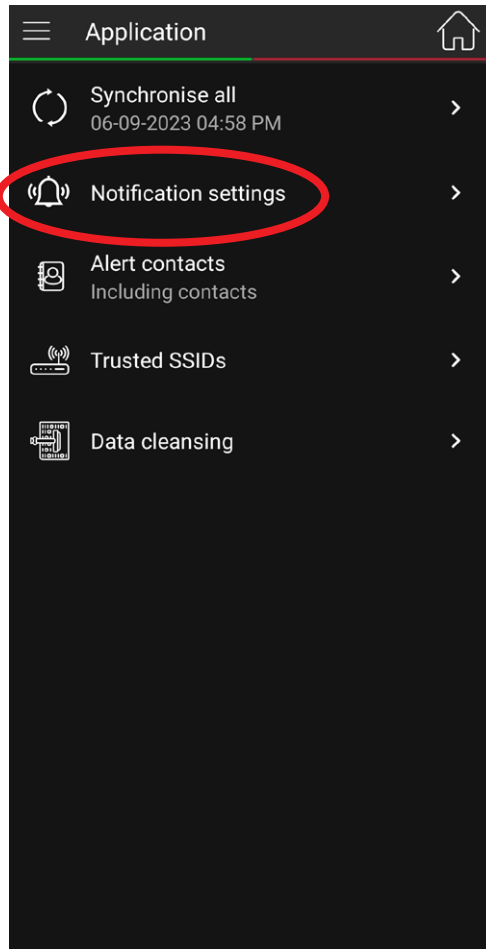

22 All notifications are enabled by default, choose your preferences.

23 Tap SUBMIT

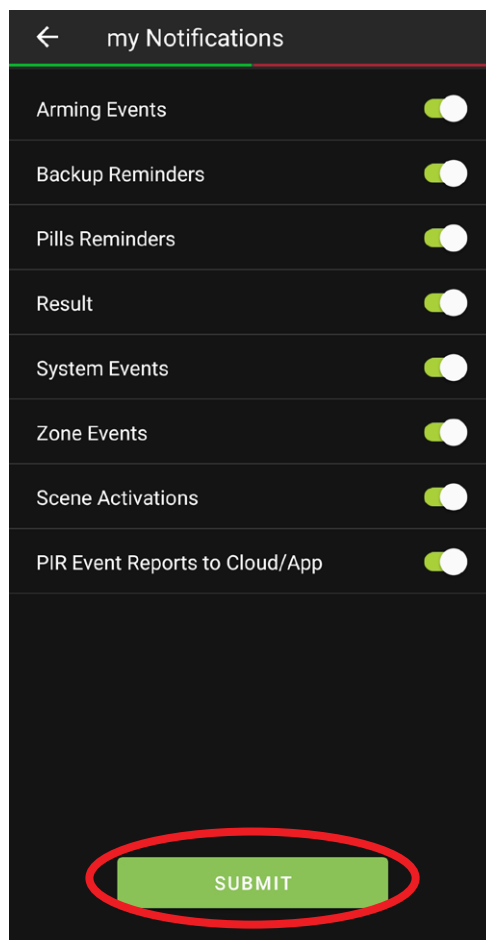

OVERVIEW - Security home screen

1 MENU, button

2 SECURITY, (this screen)

3 DEVICES, shows Zone Status and Virtual Switches

4 SCENES, set up 'Scenes' to automate actions and events. Mezzo app guides you step by step when you press + to start creating a Scene

5 CCTV, (future option)

6 EVENT WINDOW, The most recent event is displayed here

7 PANIC, trigger Panic alarm, see page 18

8 EVENTS, displays all previous events

9 ARM HOME MODE, see page 18

10 HOME, goes to app home

11 KEYPAD, for manual operation or arming/disarming areas, see page 17

Use the SLIDER for quick arming and disarming in one easy action. Slide left or right to arm or disarm.

The SLIDER also displays the panel's armed state.



Green padlock, panel is disarmed



Red padlock, panel is armed



Red padlock with perimeter, panel is armed in Home Mode

OPERATION

ARM and DISARM your panel by swiping the lock slider left to Arm All or swipe right to Disarm All.

This action uses your control panel user code as set up at step 17 to arm and disarm.

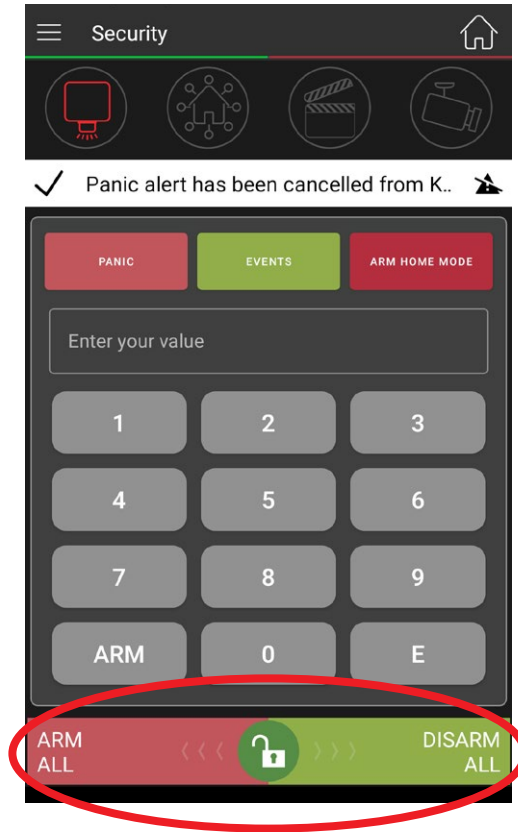

ARM / DISARM AREAS

To Arm or Disarm an Area use the app keypad as a virtual keypad.

Same as using the physical keypad simply enter:

ARM A [Your User Code] E

DISARM [Your User Code] E

The Area being operated depends on the setup of each user code in the DPlus/D8/D16 panel.

For example, User Code 1 is assigned to both Areas 1 & 2 by default.

You can also program other user codes and assign them to either Area 1 or Area 2. (this must be programmed at the control panel).

For detail see *Area Partitioning* in the DPlus/D8/D16 Installation Manual.

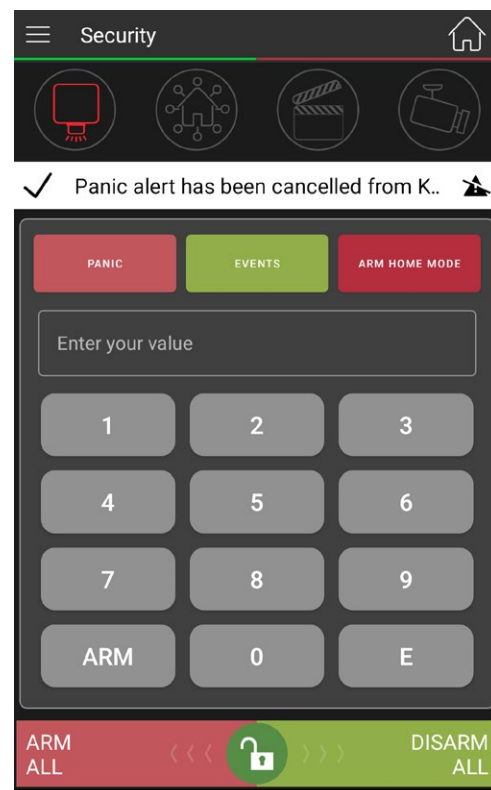

OPERATION

ARM HOME MODE

To Arm Home Mode go to *my Security* > *Arm Home Mode*.

INITIAL SETUP

In your DPlus/D8/D16 panel, in Installer Program Mode, P51E, enable the zones which will be armed in Home Mode.

DISARM HOME MODE

To Disarm Home Mode swipe the lock slider right to Disarm All.

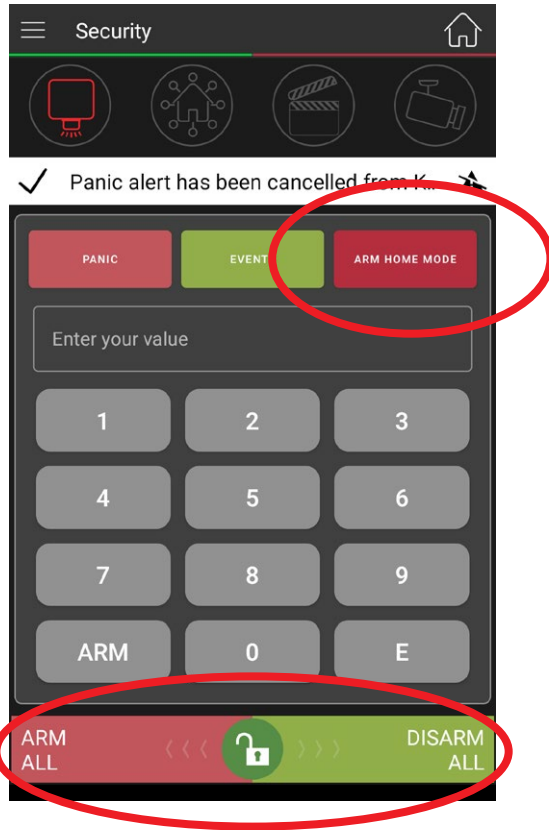

PANIC operation

To trigger a Panic alarm press PANIC.

This action will:

- Turn on the siren and strobe (if enabled in the panel).
- Trigger central station reporting¹ (if programmed).
- Send a push notification to the Mezzo app (if enabled).

¹Central station reporting requires an active SIM or landline connection and central station monitoring account which is a separate service.



PANIC function is not available in:
D8/D16 V6.x
D8/D16 V10.8

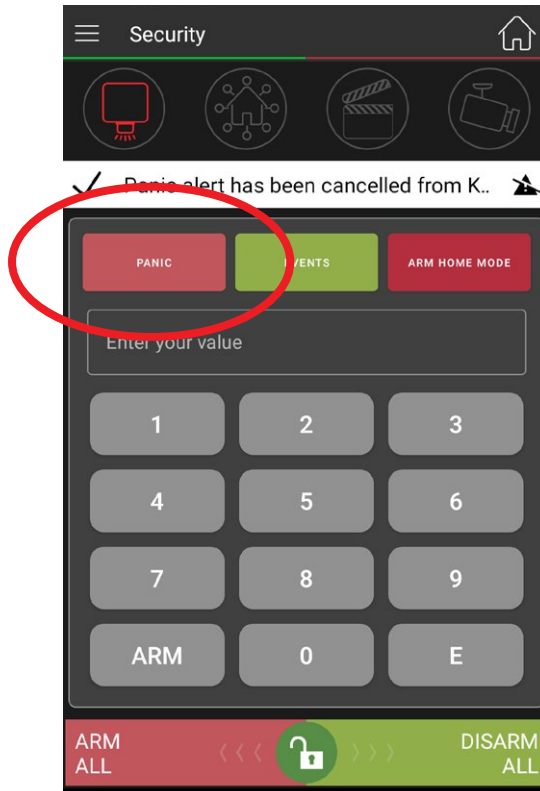

PANEL SETUP

VIRTUAL SWITCHES (DPlus/D8/D16 OUTPUTS)

Virtual Switches allows you to operate control panel Outputs 1~8 using optional 106-013 Relay Board/s.

INITIAL SETUP

In your DPlus/D8/D16 panel, in Installer Program Mode enable 'keypad operation' for the required outputs.

See P141E~P144E, enable 4E.

Requires optional 106-013 Relay Board/s or 106-011 Output Expander.

xxx corresponds to:
P141E Panel Output 1
P142E Panel Output 2
P143E Panel Output 3
P144E Panel Output 4

DPlus/D8/D16 panel, Installer Program Mode.

KPX+	PxxxE 4E enable the option to allow operation of the output via Mezzo app
NAVIGATOR	PxxxE > enable 4E

Refer to the DPlus/D8/D16 Installer Manual for further detail and setup options for additional outputs.

Operation of outputs via Mezzo app is not available in D8/D16 V6.x and D8/D16 V7.x

OPERATION

TURN OUTPUTS ON/OFF

To operate DPlus/D8/D16 outputs go to *my Security > Zones & Outputs*.

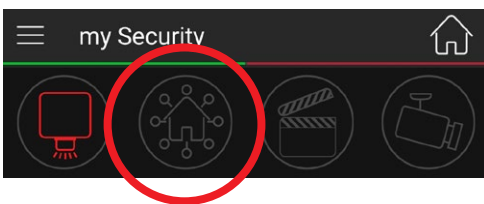

Tap each output's switch  to toggle on and off.

 Operation of OUTPUTS via Mezzo app is not available in:
D8/D16 V6.x
D8/D16 V7.x

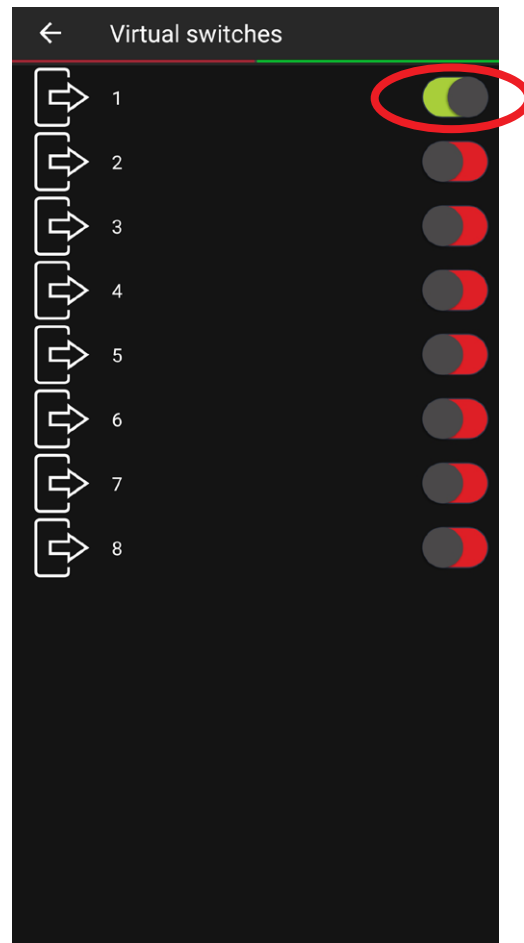

SPECIFICATIONS

NESS-BRIDGE PCB DIMENSIONS	92 x 65 x 18mm
INTERFACE	RJ45 Ethernet to local LAN / 4-wire loom to control panel
MAX. DEVICES PER MEZZO APP	10
POWER REQUIREMENT	13.8V DC via 4-wire loom to D8/D16
AVERAGE CURRENT DRAW	120mA
COMPATIBILITY	Ness DPlus, D8XD / D16XD (Rev6 and later), D8XCEL 4G / D16XCEL 4G

¹ * Outputs require optional 106-013 Relay Board/s. Other conditions apply, refer to the manual.

² Operation of outputs via Mezzo app is not supported in D8/D16 V6.x to V7.x

PANIC function is not available in D8/D16 V6.x and D8/D16 V10.8

